

# RETAIL

263 Brick Blvd  
Brick, NJ



FOR MORE INFORMATION PLEASE CONTACT EXCLUSIVE BROKER:

Grace Bosede  
O: 973.798.6130 Ext 1003  
Grace@ZoltekCRE.com

Urszula Zoltek  
O: 973.798.6130 Ext 1001  
Urszula@ZoltekCRE.com

**ZOLTEK**  
COMMERCIAL REAL ESTATE SERVICES



# AVAILABLE FOR LEASE

- 1,000 SF – Former Lighting Store
- 25 Foot Frontage
- Traffic Count Brick Blvd: 35,652
- Dry Uses Only – No Food Allowed
- Great Visibility
- Pylon Signage
- Ample Parking
- Rear Entry
- Dense Population
- Nearby National Tenants: Dunkin, Wawa, Santander's, Starbucks, Stop n Shop, Planet Fitness, Valvoline, Extra Storage, Burlington. Mavis, Roy Rogers, Pepboys Auto, 7-ELEVEN, Taco Bell, Burger King and many more.

**FOR MORE INFORMATION  
PLEASE CONTACT EXCLUSIVE BROKER:**

**Grace Bosede**

**O: 973.798.6130 Ext 1003**

**Grace@ZoltekCRE.com**

**Urszula Zoltek**

**O: 973.798.6130 Ext 1001**

**Urszula@ZoltekCRE.com**

**ZOLTEK**

**COMMERCIAL REAL ESTATE SERVICES**

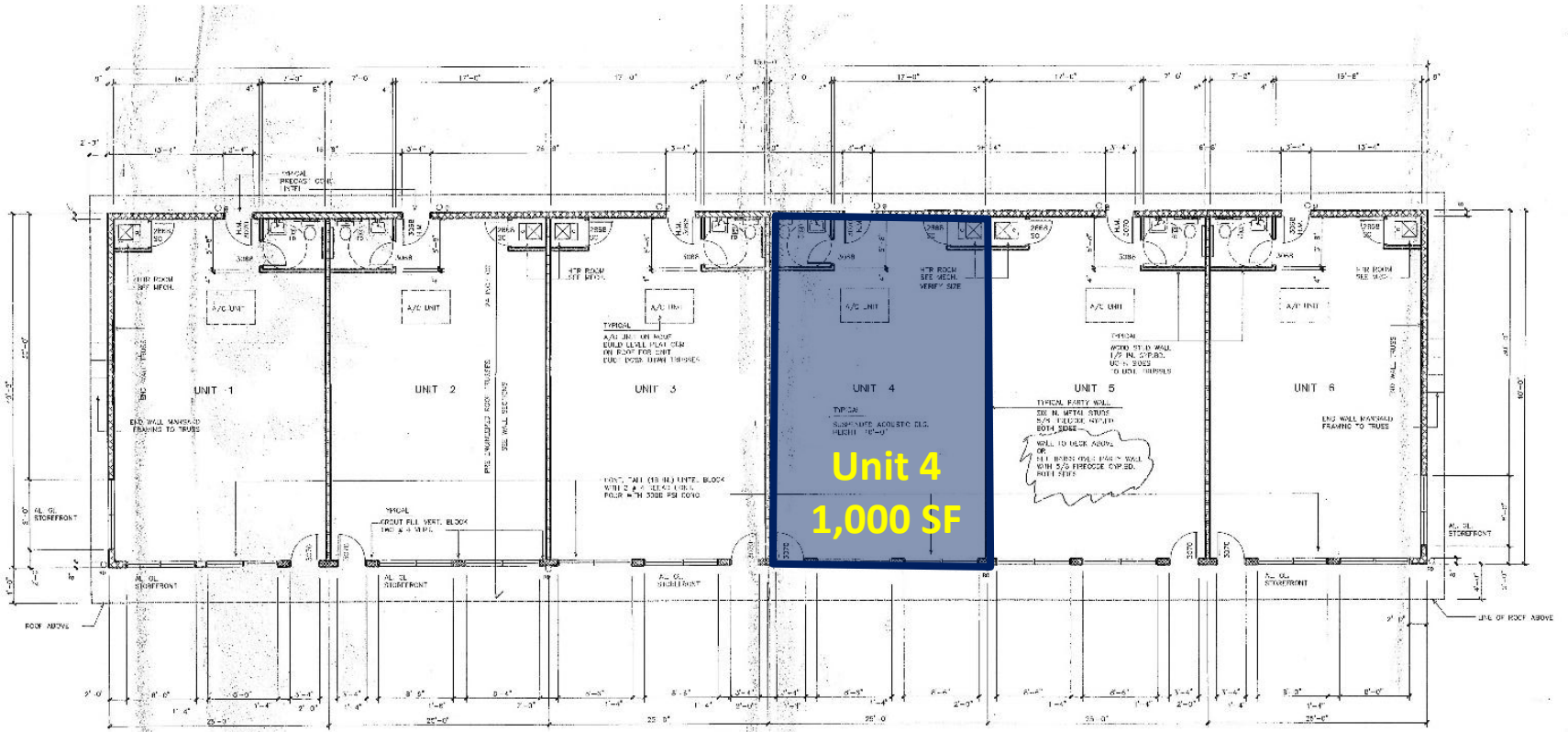

SEE  
 ENCL. BIR. PLAN  
 FOR WALL TO  
 NOT SHOWN ON ARCHITECTURAL DRAWINGS

01 FLOOR PLAN  
 1/8" = 1'-0"

ZOLTEK

**RIVERWALK**

Logos for L+DL, Harbor Freight Tools, White Castle, Outback Steakhouse, Buffalo Wild Wings, and investorsBank.

OCEANFIRST BANK

boost

Wawa

PARTY FAIR

SCHOOL OF ROCK

Drum Point Sports Center

Emma Havens Young Elementary School

THE GODDARD SCHOOL

Drum Point Elementary School

fortunoff backyard store

**SITE**

**Bay Harbor Plaza**

Logos for Starbucks Coffee, Burlington Coat Factory, M&T Bank, Valvoline, Aaron's, one dollar zone!, planet fitness, and STOP & SHOP.

Boulevard at Brick Apartment Complex

ExtraSpace Storage

CROWN BANK

Traffic Count Brick Blvd: 35,652 VPD

EXXON

TACO BELL

BURGER KING

Drum Point Plaza

PIZZA HUT

7 ELEVEN

PEPBOYS AUTO

DUNKIN'

Santander

Wawa

Public Storage

Roy Rogers

MAVIS autoCOUNT TIRE

**Brick Plaza**

Logos for TRADER JOE'S, ULTA, LAIFITNESS, PET SMART, AMC THEATRES, DSW, AutoZone, HomeGoods, Burlington, Michaels, and PNC.

Logos for 7 ELEVEN, KUMON, Carvel, and RE/MAX.

**Brick Commons**

Logos for KOHL'S + SEPHORA, DUNKIN', Sizz'N' Roll, McDonald's, Marshalls, Orangetheory FITNESS, Manhattan BAGEL, and FIVE BELOW.

**ZOLTEK**  
COMMERCIAL REAL ESTATE SERVICES



<b>Demographics</b>	<i>1 Mile</i>	<i>3 Miles</i>	<i>5 Miles</i>
Population	25,927	120,324	320,379
Daytime Employees	22,667	93,275	231,255
Households	10,953	40,501	90,842
Median Age	54.3	41.1	34.5
Average HH Income	\$81,684	\$88,933	\$91,395

**FOR FURTHER INFORMATION PLEASE  
CONTACT EXCLUSIVE AGENTS:**

**Grace Bosede**  
O: 973.798.6130 Ext 1003  
Grace@ZoltekCRE.com

**Urszula Zoltek**  
O: 973.798.6130 Ext 1001  
Urszula@ZoltekCRE.com

**ZOLTEK**  
COMMERCIAL REAL ESTATE SERVICES