

RETAIL

1541 Route 22
Watchung, NJ



FOR MORE INFORMATION PLEASE CONTACT EXCLUSIVE BROKER:

Urszula Zoltek

C: 973.896.8377

Urszula@ZoltekCRE.com

ZOLTEK
COMMERCIAL REAL ESTATE SERVICES

JOIN UNIQUE THRIFT

AVAILABLE JULY 1ST, 2024

- 10,803 SF Available for Lease
- Currently Ethan Allen Furniture Store
- Zoning: B-C Highway Commercial
- Large Pylon Sign
- 66 Combined Parking Spaces
- Traffic Count Route 22: 64,115 VPD
- Extremely Busy Highway Location
- Next Door to Watchung Square Mall
- Nearby National Tenants: Walmart, Target, The Home Depot, Bed Bath & Beyond, Shoprite, Stop n Shop, Old Navy, TJ Maxx, Staples, Dicks, BJ's, Pet Smart, ULTA, Home Sense, Chick – Fila, David's Bridal, Raymour & Flanigan, Verizon and many more.

**FOR MORE INFORMATION
PLEASE CONTACT EXECUTIVE BROKER:**

Urszula Zoltek

C: 973.896.8377

Urszula@ZoltekCRE.com

ZOLTEK

COMMERCIAL REAL ESTATE SERVICES



ZOLTEK COMMERCIAL REAL ESTATE SERVICES - Licensed Real Estate Broker – 15 Furler Street, Totowa, NJ 07512 * T: 973.798.6130

WWW.ZOLTEKCRE.COM ALTHOUGH ALL THE INFORMATION REGARDING PROPERTY FOR SALE, RENTAL OR FINANCING IS FROM SOURCES DEEMED RELIABLE SUCH INFORMATION HAS NOT BEEN VERIFIED, AND NO EXPRESS REPRESENTATION IS MADE NOR IS ANY TO BE IMPLIED AS TO THE ACCURACY THEREOF, AND IT IS SUBMITTED SUBJECT TO ERRORS, OMISSIONS, CHANGE OF PRICE, RENTAL OR OTHER CONDITIONS, PRIOR SALE, LEASE OR FINANCING, OR WITHDRAWAL WITHOUT NOTICE.

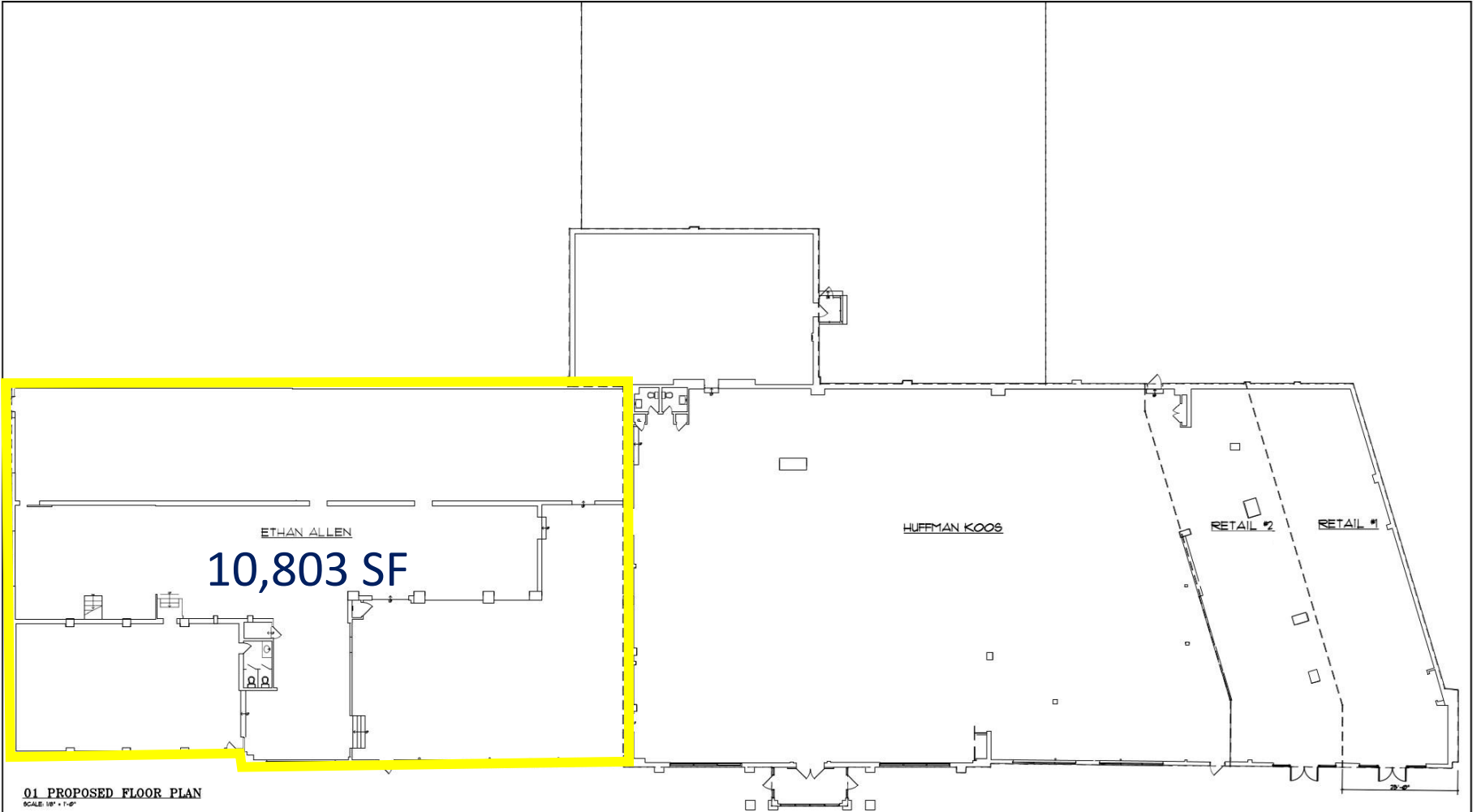

01 PROPOSED FLOOR PLAN
SCALE: 1/8" = 1'-0"

ZOLTEK
COMMERCIAL REAL ESTATE SERVICES

		PROPOSED INTERIOR DEMOLITION FOR: FORMER ETHAN ALLEN ROUTE 22 WATCHUNG, NEW JERSEY		SHEET NO. A3.1	
		DESIGNED BY: CPD	NO. DATE 00-00-00		SCALE: AS NOTED
THE DIETZ PARTNERSHIP ARCHITECTS 1000 ROUTE 22, SUITE 200 WATCHUNG, NJ 07088 TEL: 908.881.1100 FAX: 908.881.1101 WWW.DIETZPARTNERSHIP.COM		ISSUE LOG		SHEET TITLE: PROPOSED FLOOR PLAN	
DATE: 06-28-24 FOR REVIEW		DESCRIPTION:		SHEET NO.: A3.1	

SITE

Blue Star Shopping Center

KOHL'S + SEPHORA | **DOLLAR TREE** | **ShopRite** | **Wendy's**
GameStop | **FIVE GUYS** | **Marshalls**
TAL FRIDAYS | **Arbys** | **AMERICAN FREIGHT** | **THE CHILDREN'S PLACE** | **HAND+STONE** | **SALLY BEAUTY SUPPLY**

Scotch Plains Animal Hospital | **McDonald's**
Scotch Plains Diner | **LUKOIL** | **EXON** | **Little Gym**

Watchung Square Mall

Walmart | **TARGET** | **THE HOME DEPOT** | **STOP & SHOP**
BED BATH & BEYOND | **PC RICHARD & SON** | **TJ-maxx**
OLD NAVY | **DICK'S SPORTING GOODS** | **STAPLES**
KIRKLAND Signature | **DSW** | **carter's babies and kids**
AMERICA'S BEST CONTACTS & EYEGLASSES | **PET SMART**

Greenbrook Commons

B.J.'s WHOLESALE CLUB | **BUFFALO WILD WINGS** | **QDOBA MEXICAN EATS** | **EXON**

Watchung Commons

Panera BREAD | **LENSCRAFTERS** | **THE SHIRT STORE**

The Honey Baked Ham

Heritage Square

HOME SENSE | **DAVIDS BRIDAL** | **Chick-fil-e**
ULTA | **SIERRA** | **CITYMD URGENT CARE**



**Traffic Count Route 22:
64,115 VPD**





DEMO-GRAPHICS	<i>1 Mile</i>	<i>3 Miles</i>	<i>5 Miles</i>
Population	16,124	112,219	244,852
Daytime Employees	4,311	36,470	132,532
Households	5,619	36,796	83,039
Average Age	39.7	39.7	40.9
Average HH Income	\$97,998	\$125,257	\$141,653

FOR FURTHER INFORMATION PLEASE CONTACT EXCLUSIVE AGENTS:

Urszula Zoltek
C: 973.896.8377
Urszula@ZoltekCRE.com

ZOLTEK
 COMMERCIAL REAL ESTATE SERVICES