

**BRICK
CHURCH
PHARMACY**

520 Main St.
East Orange, NJ



FOR MORE INFORMATION PLEASE CONTACT EXECUTIVE BROKER:

Susan Preisler

O: 973.798.6130 Ext.1004

Susan@ZoltekCRE.com

Urszula Zoltek

O: 973.798.6130 Ext.1001

Urszula@ZoltekCRE.com

ZOLTEK

COMMERCIAL REAL ESTATE SERVICES

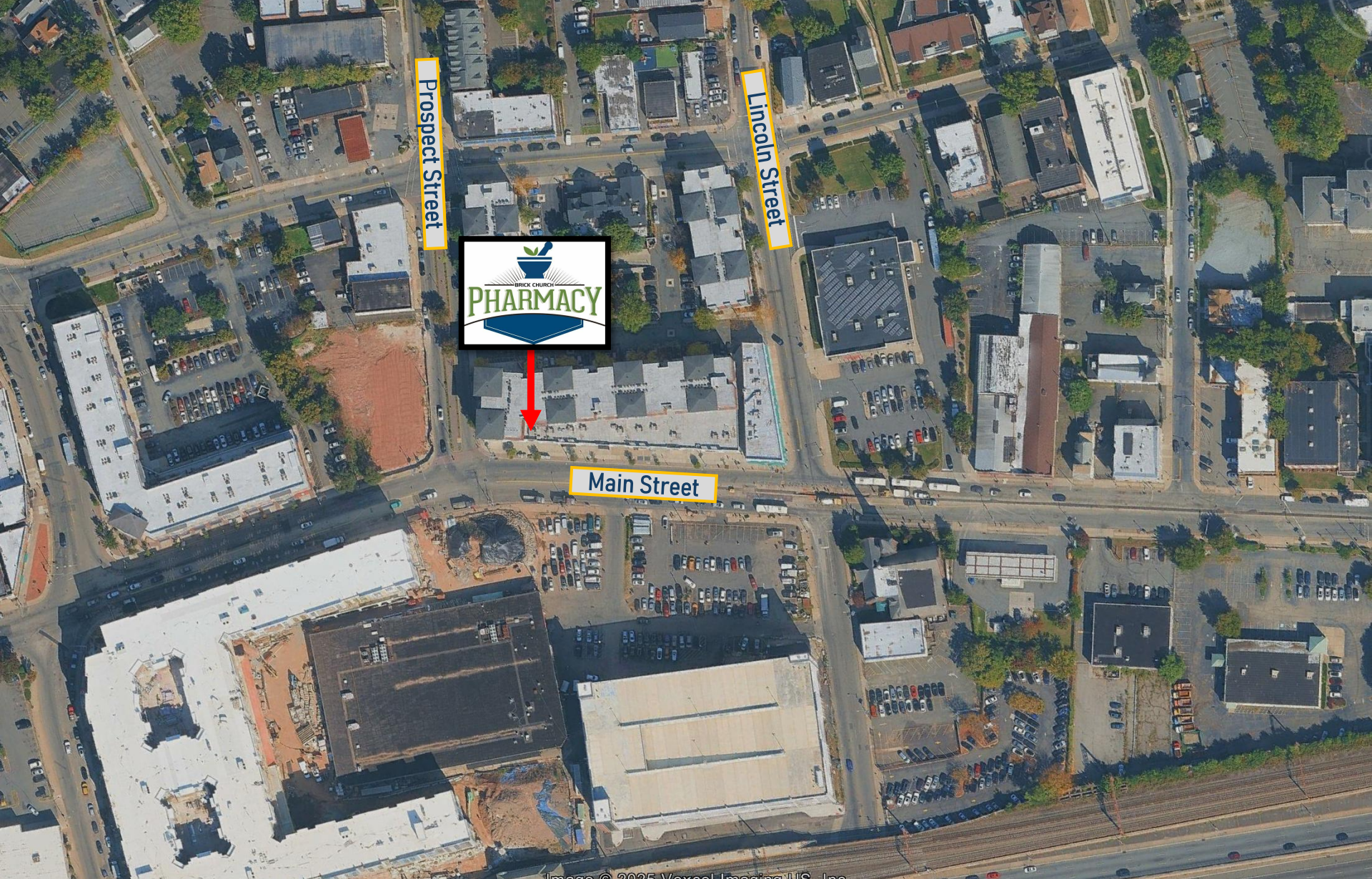

ZOLTEK COMMERCIAL REAL ESTATE SERVICES- Licensed Real Estate Broker – 15 Furler Street, Totowa, NJ 07512 * T: 973.798.6130

WWW.ZOLTEKCRE.COM ALTHOUGH ALL THE INFORMATION REGARDING PROPERTY FOR SALE, RENTAL OR FINANCING IS FROM SOURCES DEEMED RELIABLE SUCH INFORMATION HAS NOT BEEN VERIFIED, AND NO EXPRESS REPRESENTATION IS MADE NOR IS ANY TO BE IMPLIED AS TO THE ACCURACY THEREOF, AND IT IS SUBMITTED SUBJECT TO ERRORS, OMISSIONS, CHANGE OF PRICE, RENTAL OR OTHER CONDITIONS, PRIOR SALE, LEASE OR FINANCING, OR WITHDRAWAL WITHOUT NOTICE.

ZOLTEK
COMMERCIAL REAL ESTATE SERVICES

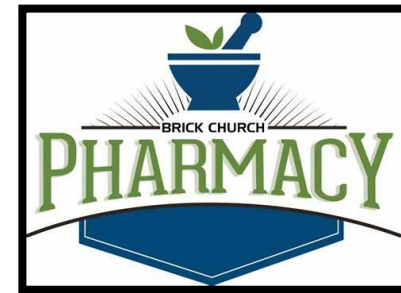
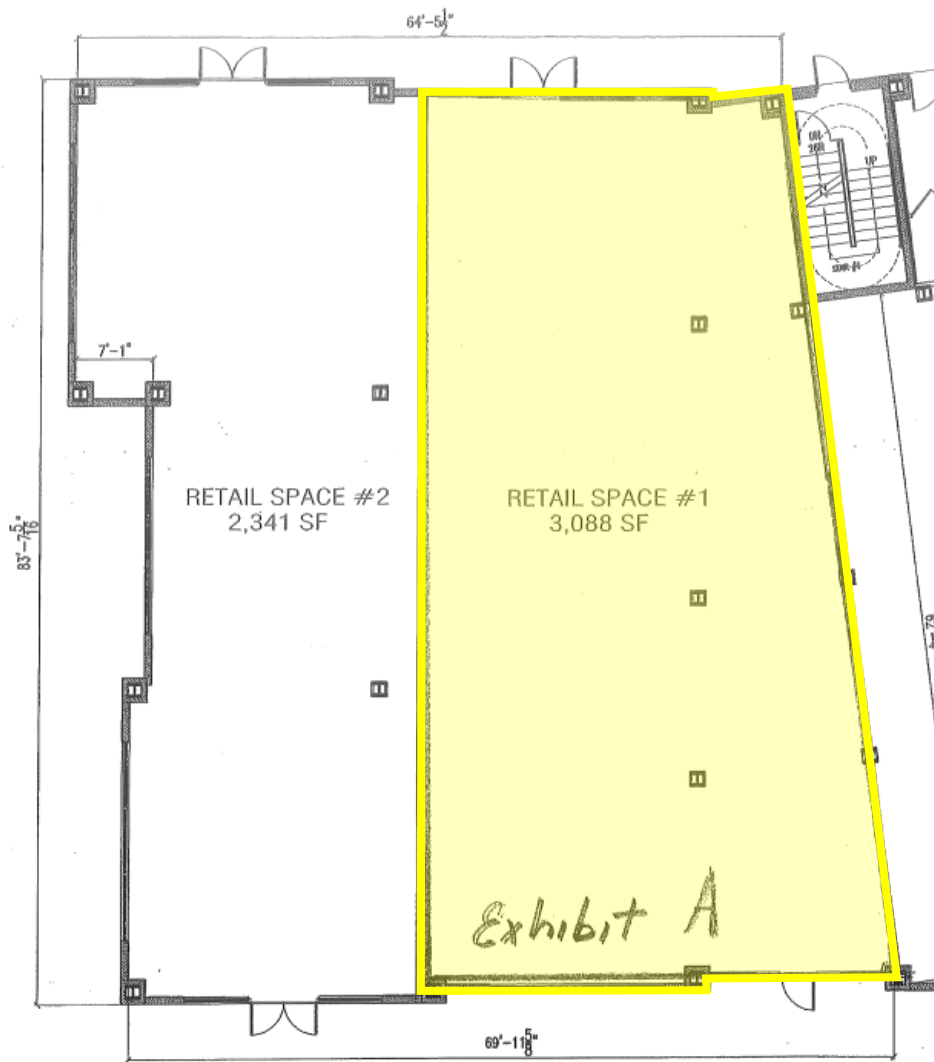

ZOLTEK COMMERCIAL REAL ESTATE SERVICES- Licensed Real Estate Broker – 15 Furler Street, Totowa, NJ 07512 * T: 973.798.6130

WWW.ZOLTEKCRE.COM ALTHOUGH ALL THE INFORMATION REGARDING PROPERTY FOR SALE, RENTAL OR FINANCING IS FROM SOURCES DEEMED RELIABLE SUCH INFORMATION HAS NOT BEEN VERIFIED, AND NO EXPRESS REPRESENTATION IS MADE NOR IS ANY TO BE IMPLIED AS TO THE ACCURACY THEREOF, AND IT IS SUBMITTED SUBJECT TO ERRORS, OMISSIONS, CHANGE OF PRICE, RENTAL OR OTHER CONDITIONS, PRIOR SALE, LEASE OR FINANCING, OR WITHDRAWAL WITHOUT NOTICE.

ZOLTEK
COMMERCIAL REAL ESTATE SERVICES