

Huge Restaurant  
Opportunity!  
**Liquor License  
Included!**

**THE NATIONAL**  
1420 Irving Street  
Rahway, NJ  
SEEKING RESTAURANT USES



FOR MORE INFORMATION PLEASE CONTACT EXCLUSIVE BROKER:

Urszula Zoltek  
973.896.8377  
Urszula@ZoltekCRE.com

**ZOLTEK**  
COMMERCIAL REAL ESTATE SERVICES



## Available for Lease

- Located Downtown in the Heart of Rahway
- Adjacent to the New Jersey Train Transit Station with Direct Connection to NYC
- Rapidly Growing Area with New Development All Around
- Stage for Concerts/Entertainment inside the Square Next Door
- Great Customer Base
- Outstanding Demographics
- High Foot Traffic

## Ground Floor – 3,175 SF (approx.) Seeking Restaurant Uses **Restaurant Space with Liquor License**

- Two Patio Areas Available for Outside Dining
- Courtyard: 1,008 SF Approx.
- Rooftop: 1,897 SF Approx.
- New Stylish Storefronts
- Huge Frontage with Great Exposure For Signage and Advertisement

[Click Here To Visit: THE RAHWAY NATIONAL](#)

FOR MORE INFORMATION  
PLEASE CONTACT EXCLUSIVE BROKER:

**Urszula Zoltek**  
**973.896.8377**  
**[Urszula@ZoltekCRE.com](mailto:Urszula@ZoltekCRE.com)**









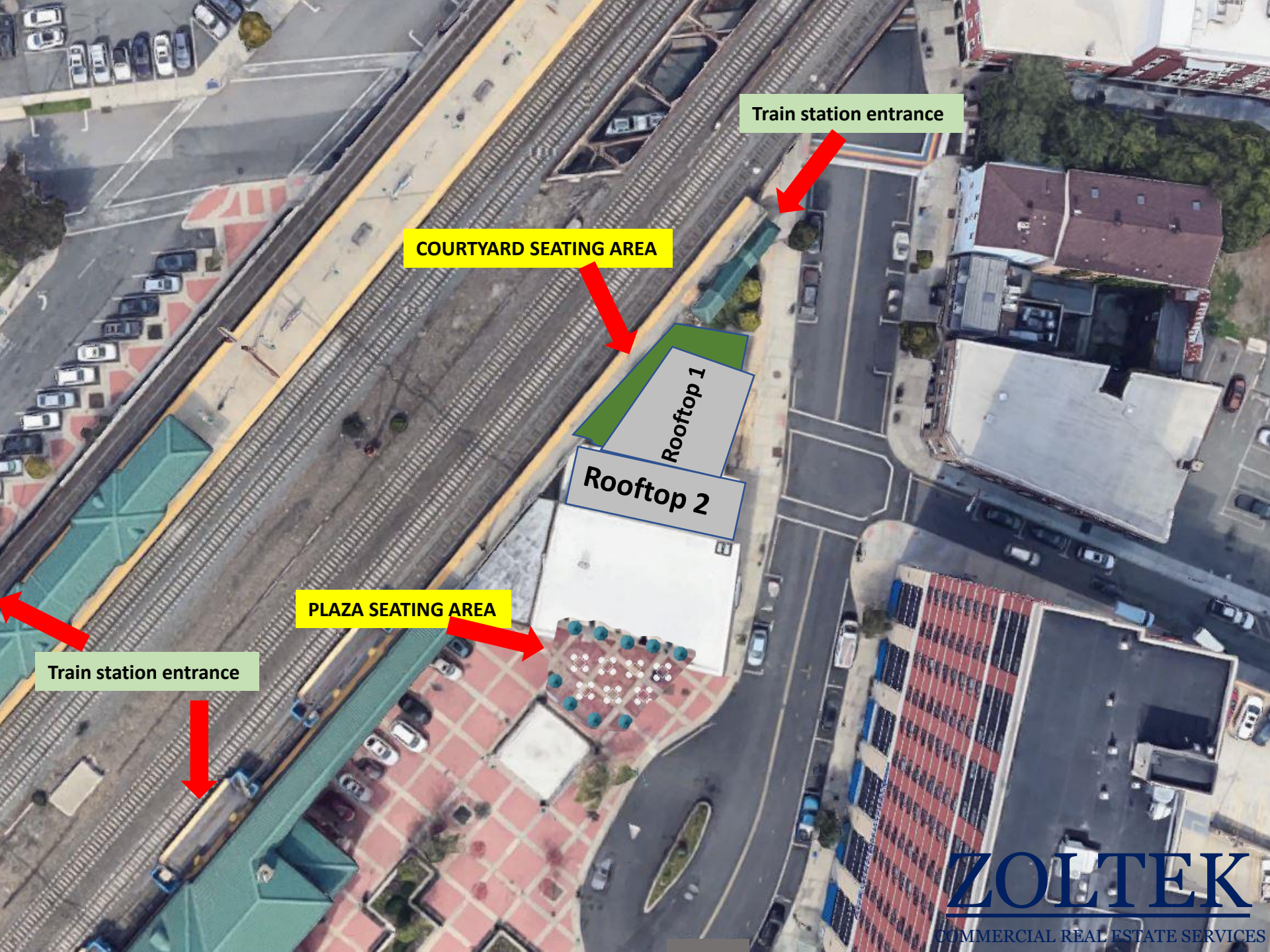

Train station entrance

COURTYARD SEATING AREA

Rooftop 1

Rooftop 2

PLAZA SEATING AREA

Train station entrance

## Ground Floor

The National

Seeking Restaurant Uses

Outdoor Seating Available

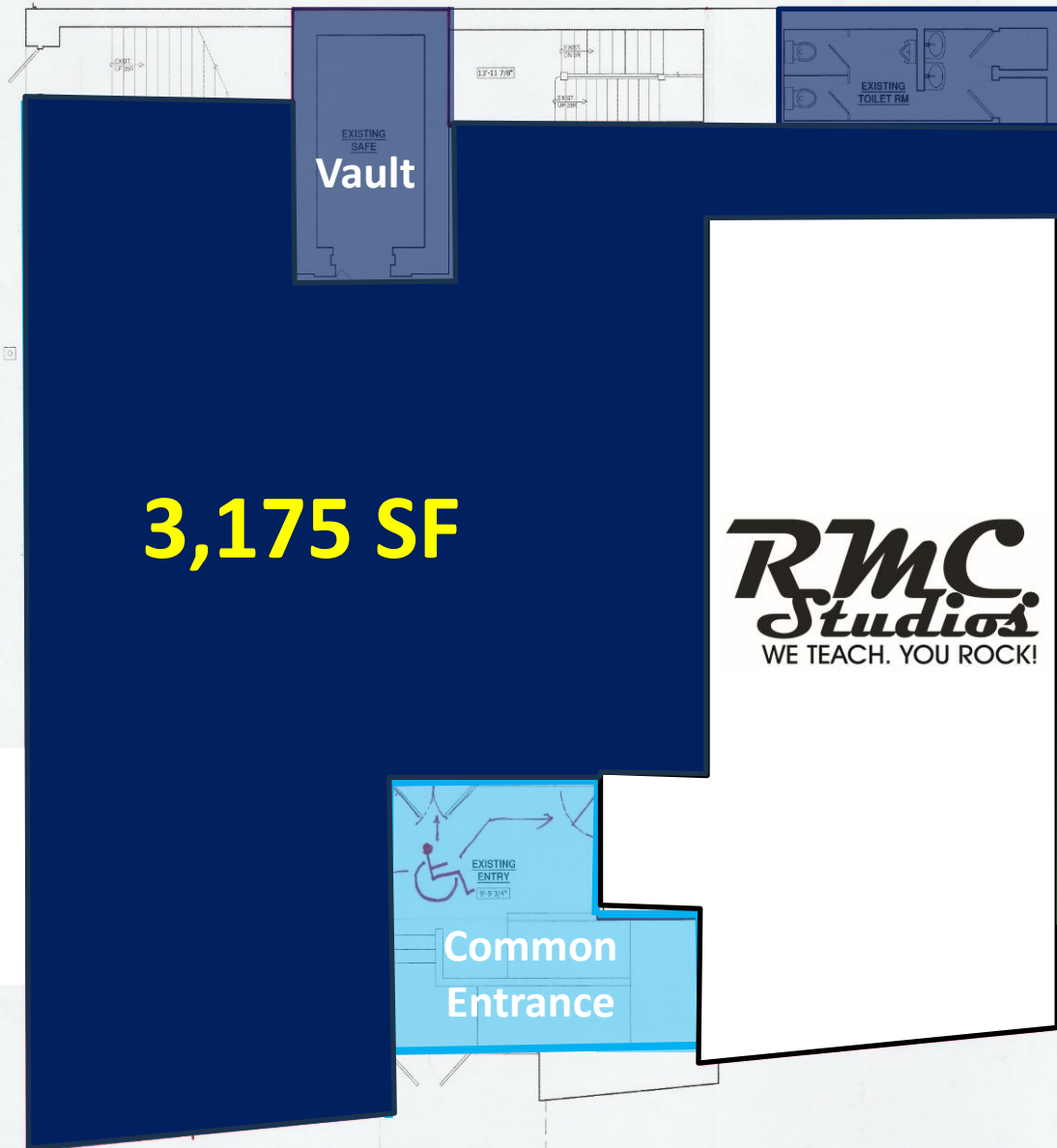

# ZOLTEK

COMMERCIAL REAL ESTATE SERVICE





ZOLTEK

SPARKTOWN  
 HISTORIC DISTRICT

# BARWAY

VISIT US ONLINE  
[WWW.BARWAYSHAPPENING.COM](http://WWW.BARWAYSHAPPENING.COM)

**BUSINESS INDEX**

| Category              | Business Name | Address         | Phone        |
|-----------------------|---------------|-----------------|--------------|
| Dining                | Barway        | 100 Central Ave | 703-438-1111 |
|                       | Barway        | 100 Central Ave | 703-438-1111 |
|                       | Barway        | 100 Central Ave | 703-438-1111 |
|                       | Barway        | 100 Central Ave | 703-438-1111 |
|                       | Barway        | 100 Central Ave | 703-438-1111 |
| Bar & Restaurant      | Barway        | 100 Central Ave | 703-438-1111 |
|                       | Barway        | 100 Central Ave | 703-438-1111 |
|                       | Barway        | 100 Central Ave | 703-438-1111 |
|                       | Barway        | 100 Central Ave | 703-438-1111 |
|                       | Barway        | 100 Central Ave | 703-438-1111 |
| Child & Grocery       | Barway        | 100 Central Ave | 703-438-1111 |
|                       | Barway        | 100 Central Ave | 703-438-1111 |
|                       | Barway        | 100 Central Ave | 703-438-1111 |
|                       | Barway        | 100 Central Ave | 703-438-1111 |
|                       | Barway        | 100 Central Ave | 703-438-1111 |
| Health & Wellness     | Barway        | 100 Central Ave | 703-438-1111 |
|                       | Barway        | 100 Central Ave | 703-438-1111 |
|                       | Barway        | 100 Central Ave | 703-438-1111 |
|                       | Barway        | 100 Central Ave | 703-438-1111 |
|                       | Barway        | 100 Central Ave | 703-438-1111 |
| Learning & Culture    | Barway        | 100 Central Ave | 703-438-1111 |
|                       | Barway        | 100 Central Ave | 703-438-1111 |
|                       | Barway        | 100 Central Ave | 703-438-1111 |
|                       | Barway        | 100 Central Ave | 703-438-1111 |
|                       | Barway        | 100 Central Ave | 703-438-1111 |
| Personal Services     | Barway        | 100 Central Ave | 703-438-1111 |
|                       | Barway        | 100 Central Ave | 703-438-1111 |
|                       | Barway        | 100 Central Ave | 703-438-1111 |
|                       | Barway        | 100 Central Ave | 703-438-1111 |
|                       | Barway        | 100 Central Ave | 703-438-1111 |
| Professional Services | Barway        | 100 Central Ave | 703-438-1111 |
|                       | Barway        | 100 Central Ave | 703-438-1111 |
|                       | Barway        | 100 Central Ave | 703-438-1111 |
|                       | Barway        | 100 Central Ave | 703-438-1111 |
|                       | Barway        | 100 Central Ave | 703-438-1111 |
| Specialty             | Barway        | 100 Central Ave | 703-438-1111 |
|                       | Barway        | 100 Central Ave | 703-438-1111 |
|                       | Barway        | 100 Central Ave | 703-438-1111 |
|                       | Barway        | 100 Central Ave | 703-438-1111 |
|                       | Barway        | 100 Central Ave | 703-438-1111 |

Produced by Sparktown Public and Private Partners  
 in collaboration with Sparktown

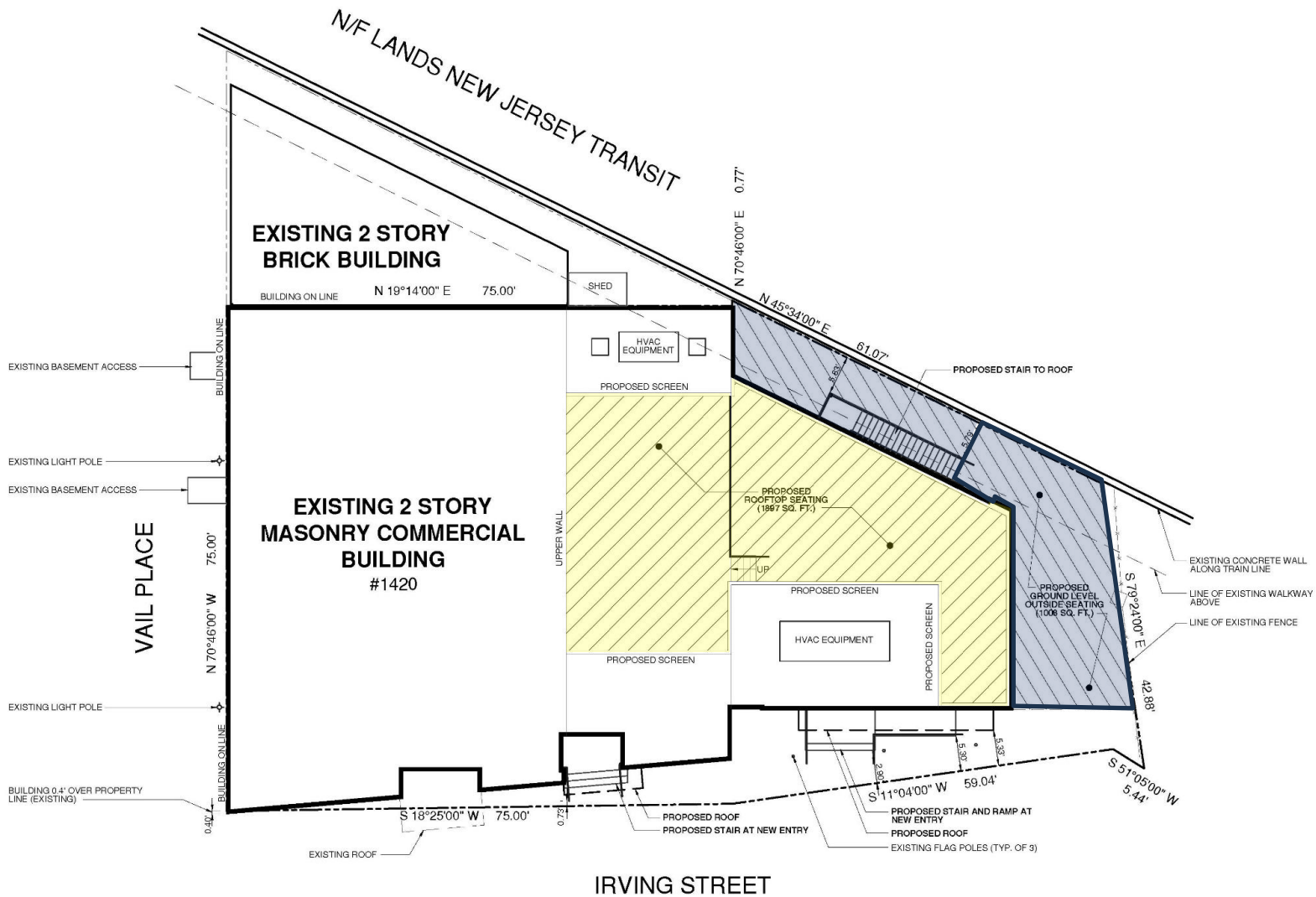

**ZOLTEK**



# Ground Floor

## The National

Z  
O  
L  
T  
E  
K

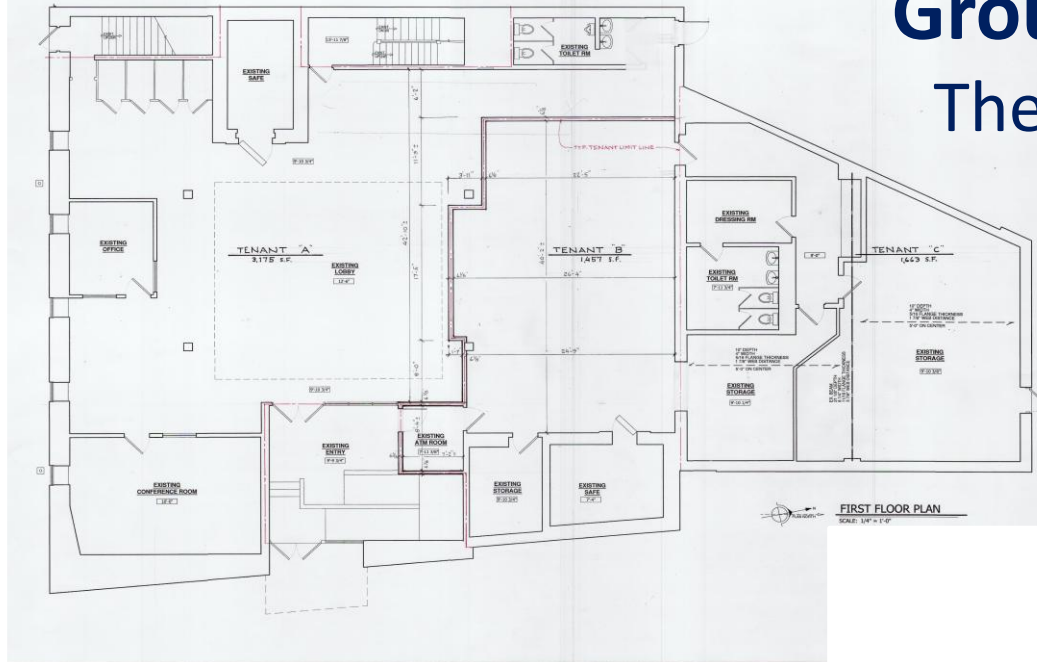





**SITE**

THE COFFEE BOX

THE IRVING INN  
*Small*

Edward Jones



Rahway Transportation Center

WATT HOTEL  
SAFETY COLLECTION  
160 Residential Units



Rahway Police Department



Rahway Municipal Administrator

Rahway Recreation Center





**HAMILTON APARTMENTS**  
58 Units



27

**RAHWAY ARTS APARTMENTS**  
20 Units

**MERIDIA BROWNSTONES**  
188 Units

**THE WILLOWS**  
57 Units

**PARK SQUARE**  
159 Units

**GRAND MERIDIA**  
88 Units

**METRO RAHWAY**  
116 Units

**THE GRAMERCY**  
42 Units

**THE MINT**  
116 Units

**MERIDIA LAFAYETTE**  
115 Units

**RIVERSIDE APARTMENTS**  
30 Units

**SITE**

**RIVER PLACE AT RAHWAY**  
136 Units

W MILTON AVENUE

**RAHWAY TRAIN STATION**  
NJ TRANSIT

**SKYVIEW**  
160 Units

**GOLDEN AGE TOWERS**  
196 Units

E MILTON AVENUE



**WATER'S EDGE**  
109 Units

**REVA RAHWAY**  
219 Units

9

**ROSEGATE APARTMENTS**  
150 Units



**ZOLTEK**

COMMERCIAL REAL ESTATE SERVICES



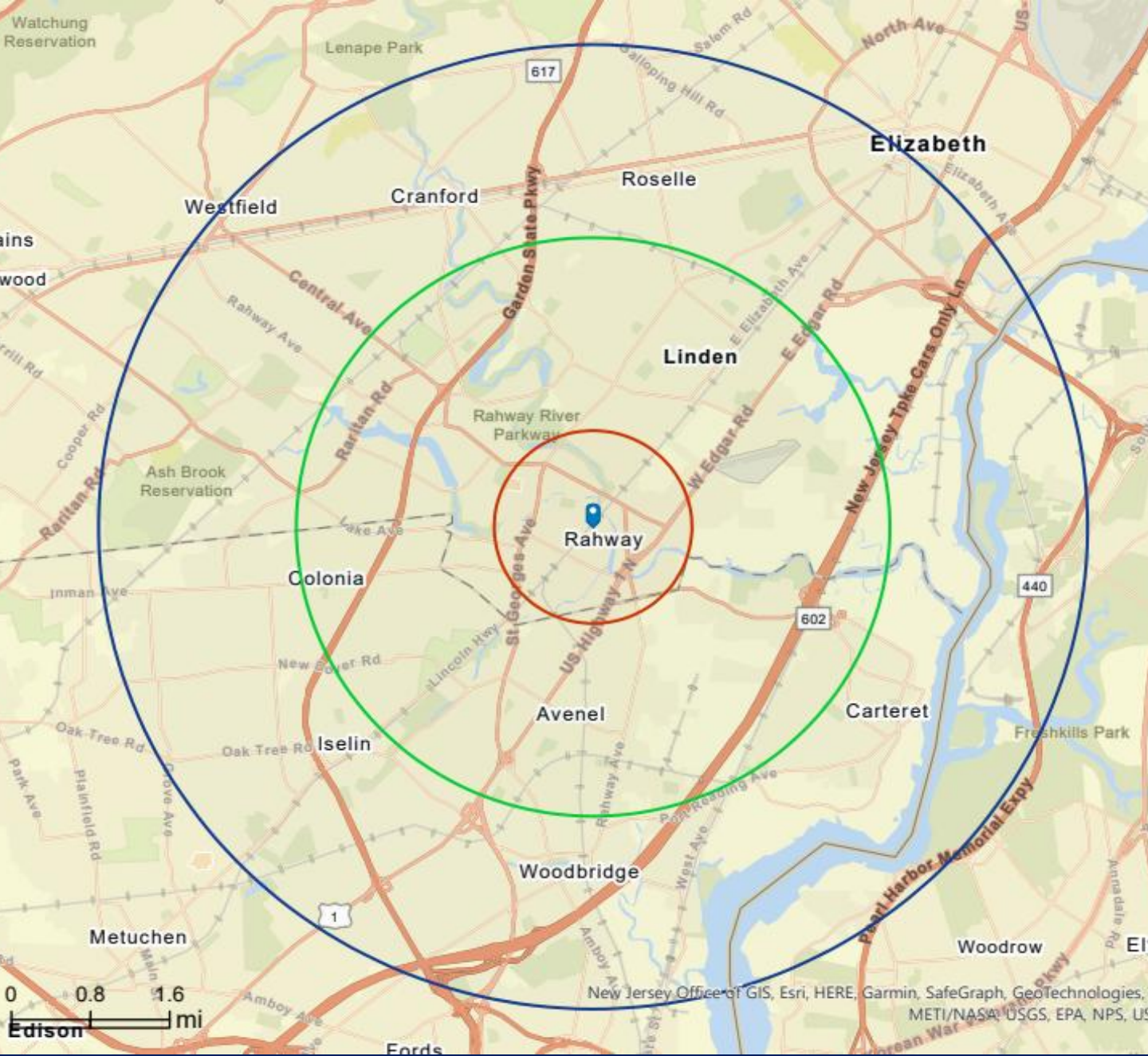

**FOR MORE INFORMATION  
PLEASE CONTACT  
EXCLUSIVE BROKER:**

**Urszula Zoltek**  
**973.896.8377**  
**Urszula@ZoltekCRE.com**

**ZOLTEK**  
COMMERCIAL REAL ESTATE SERVICES

| <i>Demo-graphics</i> | <i>1 Mile</i> | <i>3 Miles</i> | <i>5 Miles</i> |
|----------------------|---------------|----------------|----------------|
| Population           | 22,99         | 138,089        | 381,531        |
| Daytime Population   | 20,923        | 124,667        | 359,593        |
| Average HH Income    | \$70,205      | \$82,994       | \$83,088       |
| Median Age           | 39.2          | 41.5           | 40.4           |

**ZOLTEK COMMERCIAL REAL ESTATE SERVICES** - Licensed Real Estate Broker – 15 Fruler Street, Totowa, NJ 07512 \* T: 973.798.6130

**WWW.ZOLTEKCRE.COM** ALTHOUGH ALL THE INFORMATION REGARDING PROPERTY FOR SALE, RENTAL OR FINANCING IS FROM SOURCES DEEMED RELIABLE SUCH INFORMATION HAS NOT BEEN VERIFIED, AND NO EXPRESS REPRESENTATION IS MADE NOR IS ANY TO BE IMPLIED AS TO THE ACCURACY THEREOF, AND IT IS SUBMITTED SUBJECT TO ERRORS, OMISSIONS, CHANGE OF PRICE, RENTAL OR OTHER CONDITIONS, PRIOR SALE, LEASE OR FINANCING, OR WITHDRAWAL WITHOUT NOTICE.